

Models: C1050ES, C950ES, 940ESO, 940ES, 830ES

High Temperature kit

THERM and GREENTHERM



BOSCH

Technical Service Instruction

Table of contents

1	Key to symbols and safety instructions	2
1.1	Key to symbols	2
2	Introduction	3
3	Preparation	3
4	Appliance identification	3
5	Control unit service position	3
6	Therm Models	5
6.1	Jumper installation	5
6.2	Software configuration	5
7	Greentherm Models	6
7.1	Jumper installation	6
7.2	Software configuration	6

1 Key to symbols and safety instructions

1.1 Key to symbols

Warnings



Warnings in this document are identified by a warning triangle printed against a grey background.

Keywords at the start of a warning indicate the type and seriousness of the ensuing risk if measures to prevent the risk are not taken.

The following keywords are defined and can be used in this document:

- **NOTICE** indicates a situation that could result in damage to property or equipment.
- **CAUTION** indicates a situation that could result in minor to medium injury.
- **WARNING** indicates a situation that could result in severe injury or death.
- **DANGER** indicates a situation that will result in severe injury or death.

Important information



This symbol indicates important information where there is no risk to people or property.

Additional symbols

Symbol	Explanation
▶	Step in an action sequence
→	Cross-reference to another part of the document
•	List entry
–	List entry (second level)

Table 1

2 Introduction



Note: The installation of this high temperature kit will reduce the heat exchanger warranty to 5 years from the date of original installation and operation. For more details consult the water heater's installation manual for warranty period.

Tools needed:

- Phillips head screw driver
- Small flat head screw driver
- Needle-nosed pliers



NOTICE: Damages to the PCB!

- ▶ Avoid touching printed circuit board (PCB) as static discharge may damage circuitry.



DANGER: Risk of fatal injury from electric shock!

- ▶ Before servicing the water heater, unplug power supply cord from outlet. Failure to do so could result in severe personal injury or death.

3 Preparation

- ▶ Push power button to "OFF" and unplug power cord.
- ▶ Loosen two Phillips head screws on bottom rear of front cover.
- ▶ Pull cover bottom outwards then lift cover upwards to remove.

4 Appliance identification

The high temperature activation is different for Therm and Greentherm models. Here is how to identify which model you have:

Type	Model Number	Model
Greentherm	7 736 501 516	C950ES NG
	7 736 501 518	C950ES LP
	7 736 501 515	C1050 ES NG
	7 736 501 517	C1050 ES LP
Therm	7 703 311 081	C950ES NG
	7 703 411 077	C950ES LP
	7 703 311 074	C1050ES NG
	7 703 411 072	C1050ES LP
	7 703 311 076	830ES NG
	7 703 411 074	830ES LP
	7 703 311 075	940ES NG
	7 703 411 073	940ES LP
	7 703 311 071	940 ESO NG
	7 703 411 069	940 ESO LP

Table 2

For Therm models see chapter 6, for Greentherm models see chapter 7.

5 Control unit service position

- ▶ Remove three Phillips screws on front of control unit (Fig. 1, pos. 1).

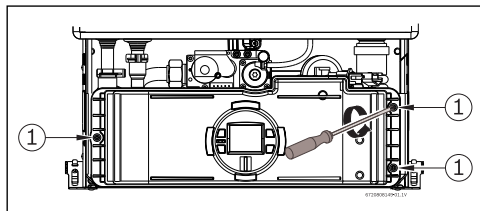

Fig. 1 Control unit front

- ▶ Turn control unit to expose the rear.

4 | Control unit service position

- ▶ Remove rear hatch from control unit to expose circuit board electrical connections. (Fig. 2, pos. 3).

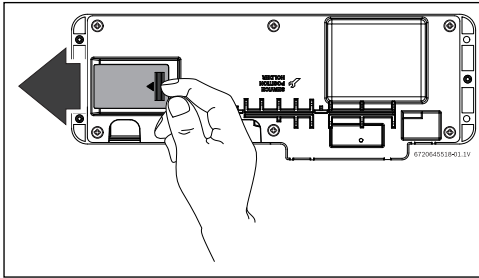

Fig. 2 Control unit rear

- ▶ Control unit rear (wiring not shown for clarity purposes).

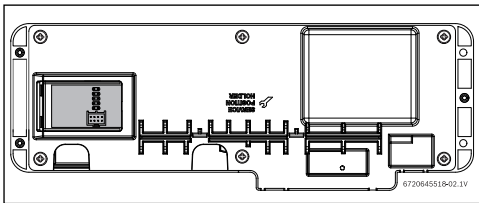

Fig. 3 Control unit rear

6 Therm Models

6.1 Jumper installation

- ▶ Jumpers 5 and 6 may also be populated based on the model. Do not remove those jumpers.

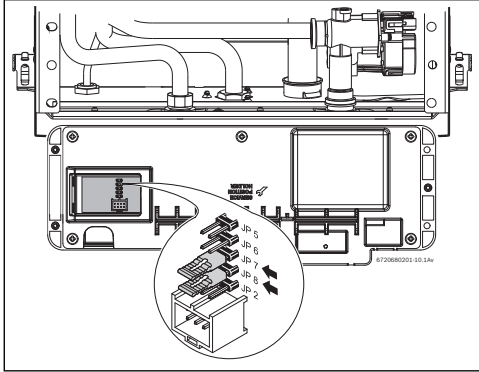

Fig. 4 Optional jumpers 5 and 6 not shown for clarity.

- ▶ Install jumpers from the kit on positions JP7 and JP8.
- ▶ Reinstall the rear hatch.
- ▶ Reinstall the control unit securing the 3 Philips head screws.
- ▶ Plug in power cord.

Jumper	Temperature range	
	ON	OFF (default)
JP7 + JP8	38 °C - 84 °C	38 °C - 60 °C
	100 °F - 184 °F	100 °F - 140 °F

Table 3



For DHW recirculating applications, see Technical Service Bulletin AP-03 Direct Recirculation, to avoid damage in internal components.

6.2 Software configuration

Setting the desired hot water temperature:

- ▶ Power on the appliance by pressing the  On/Off button.

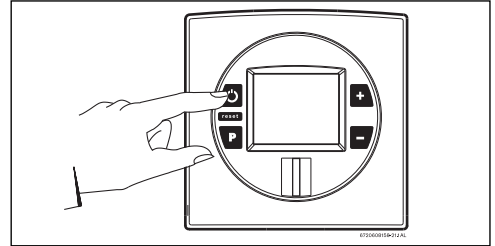



Fig. 5

- ▶ Press the  button in order to reach temperatures above 140 °F (60 °C).

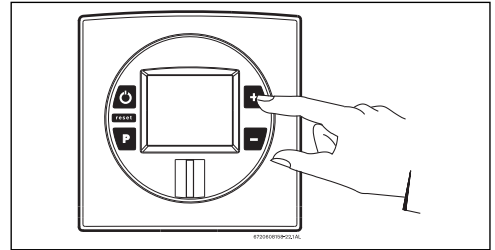

Fig. 6

The Therm appliance is now set at the desired elevated temperature.

7 Greentherm Models

7.1 Jumper installation

- ▶ Install jumpers from the kit on positions JP2 and JP5.

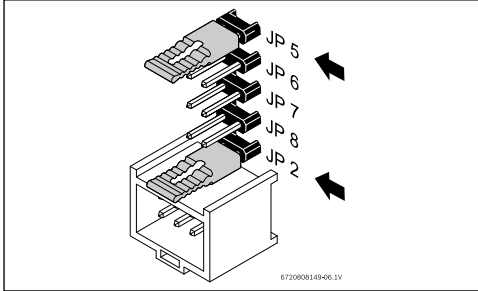

Fig. 7 Jumper configuration

Temperature range	
C	H
38 °C - 84 °C	38 °C - 60 °C
100 °F - 184 °F	100 °F - 140 °F

Table 4

7.2 Software configuration

1. Press ON/OFF button  into ON.
2. The key symbol must appear on the display (Fig. 8).

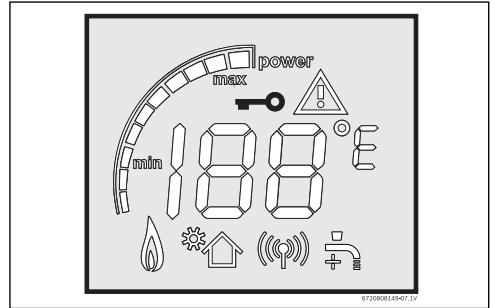





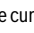

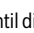

Fig. 8 Key symbol

3. Press and hold buttons  or  and  simultaneously for 3 seconds, until display reads P2.
4. Use the  or  button to cycle through different programs modes, until display shows PE.
5. Press  to enter PE adjustment. The current setting will appear on the display. If not, repeat process.
6. Use the  or  button on the control board to select "C".
7. Hold the  button for 5 seconds until display flashes selection "C".
8. Press ON/OFF button to turn OFF the appliance.
9. Remove the jumpers from the PCB and store them with the technical documentation.



From now on the temperature range is 100 °F - 184 °F.

- ▶ Reinstall the rear hatch.
- ▶ Reinstall the control unit securing the 3 Philips head screws.
- ▶ Plug in power cord.



For DHW recirculating applications, see Technical Service Bulletin AP-03 Direct Recirculation, to avoid damage in internal components.

To adjust the temperature:

- ▶ Power on the appliance by pressing the  On/Off button.

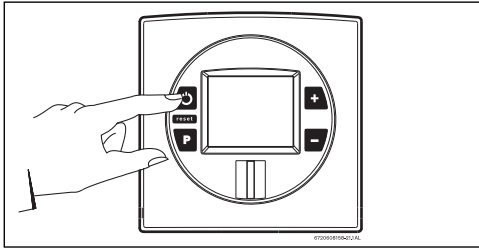



Fig. 9

- ▶ Press the  button in order to reach temperatures above 140 °F (60 °C).

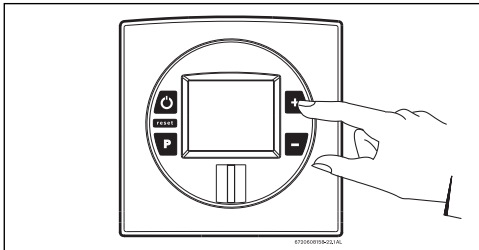

Fig. 10



Bosch Thermotechnology Corp.
50 Wentworth Avenue
Londonderry, NH 03053
Tel. 603-552-1100
Fax 603-965-7581
www.bosch-climate.us
U.S.A.

Bosch Thermotechnology Corp. reserves the right to make changes without notice due to continuing engineering and technological advances.