

# Technical Service Bulletin: Gas Conversion

Models: Bosch Greenstar Combi, Bosch Greenstar



# BOSCH

## Introduction

The range of Bosch Greenstar boilers are supplied in ready to use on Natural Gas (NG). If the installation requires Liquid Propane (LP) as the fuel then the boiler will have to be converted.



**A calibrated flue gas combustion analyzer must be used in order to complete the gas conversion process.**

## Conversion to LP Gas

The information regarding how to convert the boiler from NG to LP is contained within the installation manual, but as a summary, the process is as follows.

The “code plug” that is provided with the boiler is set for natural gas. This will have to be changed for the LP “code plug”, by removing the rear cover from the electrical panel, removing the NG code plug and replacing it with the LP code plug (see Fig.1).

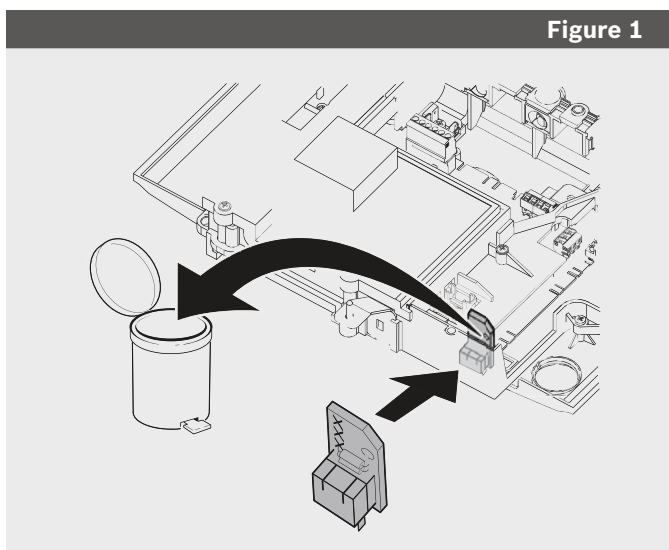

Figure 1



**There is no ‘orifice’ to be changed in this conversion process.**

Once this has been changed the boiler **MUST** be re-commissioned with a flue gas combustion analyzer. See table below for CO<sub>2</sub> or O<sub>2</sub> values at maximum and minimum nominal output.

Gas type	Maximum nominal output		Minimum nominal output	
	CO <sub>2</sub>	O <sub>2</sub>	CO <sub>2</sub>	O <sub>2</sub>
NG	9.4%	4.0%	8.6%	5.5%
LPG (propane)	11.0%	4.2%	10.4%	5.1%

If the contractor/commissioning engineer does not have a calibrated flue gas combustion analyzer on site then the boiler **MUST NOT** be used, until it has been re-commissioned to the required parameters stated in the Bosch Greenstar installation manual.

The boiler commissioning process for NG and LP can be found in the Bosch Greenstar installation manual.



**To commission any of the Bosch Greenstar range, a flue gas analyzer must be used whether the fuel is NG or LP.**

For further information please contact Bosch Technical Services  
Tel - 1 800 283 3787.



# BOSCH

Bosch Thermotechnology Corp.  
50 Wentworth Avenue  
Londonderry, NH 03053

Tel: 1-800-283-3787  
Fax: 1-603-965-7581  
www.bosch-climate.us